

BOTADORES CON HOMBRO

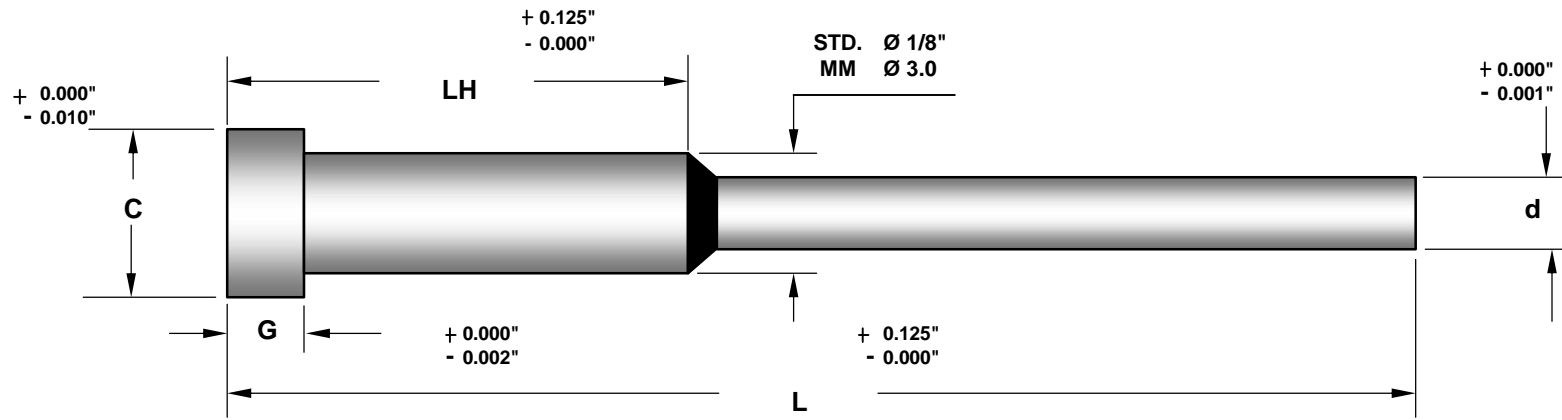

No. CATALOGO	d		C		G		LH		L									
	DIAM. PERNO		DIAM. CAB.		GRUESO CAB.		LONG. HOMBRO		LONGITUDES				EXISTENTES					
	PULG.	MM	PULG.	MM	PULG.	MM	PULG.	MM	PULG.	MM	PULG.	MM	PULG.	MM	PULG.	MM	PULG.	MM
MEDIDAS ESTANDAR																		
B-46	3/64"	1.19	1/4"	6.35	1/8"	3.175	1/2"	12.7	4"	101.6	6"	152.4	10"	254	-	-	-	-
B-46	3/64"	1.19	1/4"	6.35	1/8"	3.175	2"	50.8	4"	101.6	6"	152.4	10"	254	-	-	-	-
B-62	1/16"	1.588	1/4"	6.35	1/8"	3.175	1/2"	12.7	4"	101.6	6"	152.4	10"	254	-	-	-	-
B-62	1/16"	1.588	1/4"	6.35	1/8"	3.175	2"	50.8	4"	101.6	6"	152.4	10"	254	-	-	-	-
B-78	5/64"	1.984	1/4"	6.35	1/8"	3.175	1/2"	12.7	4"	101.6	6"	152.4	10"	254	-	-	-	-
B-78	5/64"	1.984	1/4"	6.35	1/8"	3.175	2"	50.8	4"	101.6	6"	152.4	10"	254	-	-	-	-
B-93	3/32"	2.381	1/4"	6.35	1/8"	3.175	1/2"	12.7	4"	101.6	6"	152.4	10"	254	-	-	-	-
B-93	3/32"	2.381	1/4"	6.35	1/8"	3.175	2"	50.8	4"	101.6	6"	152.4	10"	254	-	-	-	-
B-109	7/64"	2.778	1/4"	6.35	1/8"	3.175	1/2"	12.7	4"	101.6	6"	152.4	10"	254	-	-	-	-
B-109	7/64"	2.778	1/4"	6.35	1/8"	3.175	2"	50.8	4"	101.6	6"	152.4	10"	254	-	-	-	-
MEDIDAS MILIMETRICAS																		
BM-1.5	0.059"	1.5	0.157"	4	0.079"	2	1.969"	50	3.937"	100	4.921"	125	5.906"	150	7.874"	200	9.843"	250
BM-2.0	0.079"	2	0.157"	4	0.079"	2	1.969"	50	3.937"	100	4.921"	125	5.906"	150	7.874"	200	9.843"	250
BM-2.5	0.098"	2.5	0.197"	5	0.079"	2	1.969"	50	3.937"	100	4.921"	125	5.906"	150	7.874"	200	9.843"	250